

**R-12 Roto Lock**

Specifications	Part No.
No. 10, Thread: 7/8"-14	<b>1408001</b>
No. 8, Thread: 3/4"-16	<b>1408002</b>



1/4" Port R-12 Back Seat Flare Fitting

Specifications	Part No.
No. 8, Thread: 3/4"-16	<b>1408003</b>
No. 10, Thread: 7/8"-14	<b>1408004</b>



1/4" Port R-12 Back Seat O-Ring Fitting

Specifications	Part No.
No. 10	<b>1408005</b>
No. 8	<b>1408006</b>



1/4" Port R-12 Top Port Service Valve

Specifications	Part No.
No. 8, Thread: 3/4"-16	<b>1408007</b>
No. 10, Thread: 7/8"-14	<b>1408008</b>

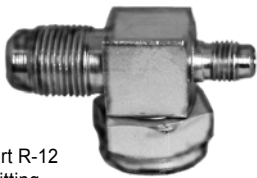

1/4" Port R-12 Flare Fitting

Specifications	Part No.
No. 8, Thread: 3/4"-16	<b>1408009</b>
No. 10, Thread: 7/8"-14	<b>1408010</b>

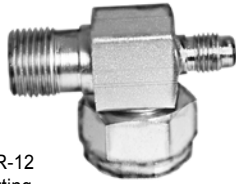

1/4" Port R-12 O-Ring Fitting

Specifications	Part No.
No. 8, Hose I.D.: 13/32"	<b>1408011</b>
No. 10, Hose I.D.: 1/2"	<b>1408012</b>

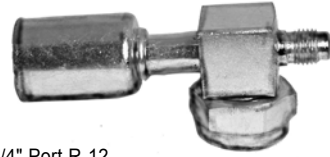

1/4" Port R-12 Beadlock Fitting

**R-12 Tube O-Ring**

Specifications	Part No.
No. 8 Fitting, 3/4"-16 Thread	<b>1408013</b>
No. 10 Fitting, 7/8"-14 Thread	<b>1408014</b>

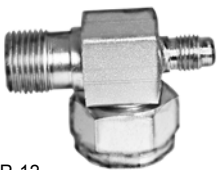

1/4" Port R-12 O-Ring Fitting

Specifications	Part No.
No. 8 Fitting, 3/4"-16 Thread	<b>1408015</b>
No. 10 Fitting, 7/8"-14 Thread	<b>1408016</b>



1/4" Port R-12 Back Seat Flare Fitting

Specifications	Part No.
No. 8, Hose I.D.: 13/32"	<b>1408017</b>
No. 10, Hose I.D.: 1/2"	<b>1408018</b>
No. 12, Hose I.D.: 5/8"	<b>1408019</b>

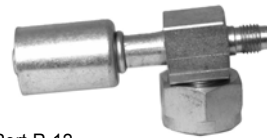

1/4" Port R-12 Beadlock Fitting

Specifications	Part No.
No. 8 Fitting, 3/4"-16 Thread	<b>1408020</b>
No. 10 Fitting, 7/8"-14 Thread	<b>1408021</b>

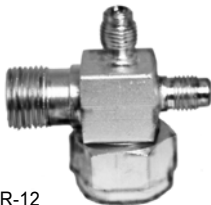

1/4" Port R-12 O-Ring Fitting

**COMPRESSORS**



**R-134a Roto Lock**

Specifications	Part No.
No. 8, 16mm, 3/4"-16 Thread	<b>1408022</b>
No. 10, 13mm, 7/8"-14 Thread	<b>1408023</b>

1"-14 Standard Flow Back Seat R-134a Port O-Ring Fitting



Specifications	Part No.
No. 8 Thread: 3/4"-16	<b>1408024</b>
No. 10 Thread: 7/8"-14	<b>1408025</b>

1"-14 Standard Flow R-134a Port O-Ring Fitting



Specifications	Part No.
No. 8, 16mm, 13/32" Hose I.D.	<b>1408026</b>
No. 10, 13mm, 1/2" Hose I.D.	<b>1408027</b>

1"-14 Standard Flow R-134a Port Beadlock Fitting



**R-134a Tube O-Ring**

Specifications	Part No.
3/4"-16 Tube O-Ring	<b>1408028</b>

Top Port R-134a

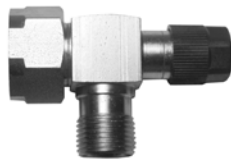

Specifications	Part No.
7/8"-14 Tube O-Ring	<b>1408029</b>

Top Port R-134a



Specifications	Part No.
No. 8, 16mm, 3/4"-16 Thread	<b>1408030</b>
No. 10, 13mm, 7/8"-14 Thread	<b>1408031</b>

1"-14 Standard Flow Back Seat R-134a Port O-Ring Fitting



Specifications	Part No.
3/4"-16 Tube O-Ring	<b>1408032</b>

Discharge R-134a



Specifications	Part No.
7/8"-14 Tube O-Ring	<b>1408033</b>

Discharge R-134a



Specifications	Part No.
No. 8, 16mm, 3/4"-16 Thread	<b>1408034</b>
No. 10, 13mm 7/8"-14 Thread	<b>1408035</b>

1"-14 Standard Flow R-134a Port O-Ring Fitting

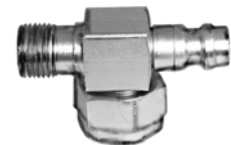

Specifications	Part No.
No. 8, 16mm, 13/32" Hose I.D.	<b>1408036</b>
No. 10, 13mm, 1/2" Hose I.D.	<b>1408037</b>
No. 12, 13mm, 5/8" Hose I.D.	<b>1408038</b>

1"-14 Standard Flow R-134a Port Beadlock Fitting

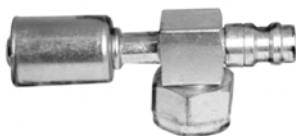

Specifications	Part No.
No. 8, 16mm, 3/4"-16 Thread	<b>1408039</b>
No. 10, 13mm, 7/8"-14 Thread	<b>1408040</b>

1"-14 High Flow R-134a Port O-Ring Fitting

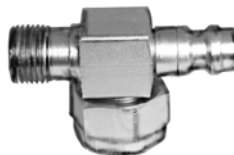

**COMPRESSORS**



CCI & Tecumseh (continued)

## R-134a Flange

Specifications	Part No.
No. 8, 16mm High, 3/4"-16 Thread	<b>1408041</b>
No. 10, 13mm Low, 7/8"-14 Thread	<b>1408042</b>

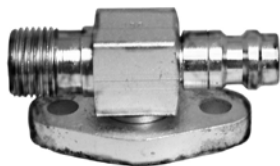

Standard Flow R-134a  
O-Ring Fitting

## Ford (R-12 & R-134a)

Specifications	Part No.
3/4"-16 UNF2A Thread, Hose: No. 8, 3/4"-16 Thread	<b>1408043</b>
7/8"-14 UNF2A Thread, Hose: No. 10, 7/8"-14 Thread	<b>1408044</b>

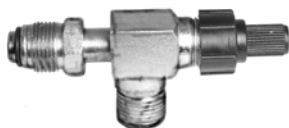

**Ford In-Line**  
Back Seat Valve R-12 & R-134a  
O-Ring Fitting

Specifications	Part No.
M20 Thread, Hose: No. 8, 3/4"-16 Thread	<b>1408045</b>



**Ford Metric**  
Back Seat Valve R-12 & R-134a  
O-Ring Fitting

Specifications	Part No.
M24 Thread, Hose: No. 10, 7/8"-14 Thread	<b>1408046</b>

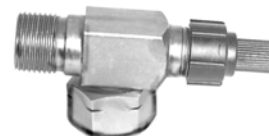

**Ford Metric**  
Back Seat Valve R-12 & R-134a  
O-Ring Fitting

## Diesel Kiki & Sanden (R-12 & R-134a)

Specifications	Part No.
3/4"-16 Thread, Hose: No. 8, 3/4"-16 Thread	<b>1408047</b>
7/8"-14 UNF2A Thread, Hose: No. 10, 7/8"-14 Thread	<b>1408048</b>



1/4" Service Ports R-12  
O-Ring Fitting  
**w/o Service Ports on compressor**

Specifications	Part No.
3/4"-16 Thread, 16mm Service Port, Hose: No. 8, 3/4"-16 Thread	<b>1408049</b>
7/8"-14 UNF2A Thread, 13MM Service Port, Hose: No. 10, 7/8"-14 Thread	<b>1408050</b>



Standard Flow R-134a  
O-Ring Fitting  
**w/o Service Ports on compressor**

Specifications	Part No.
3/4"-16 Thread, 16mm Service Port, Hose: No. 8, 3/4"-16 Thread	<b>1408051</b>
7/8"-14 UNF2A Thread, 13MM Service Port, Hose: No. 10, 7/8"-14 Thread	<b>1408052</b>



Standard Flow R-134a  
O-Ring Fitting  
**w/o Service Ports on compressor**

COMPRESSORS



# Service Valve Specifications

## R-12 & R-134a Service Valve Specifications

Description	Compressor Thread Size	Hose Fittings			Refrigerant Hose		Part No.
		Type	Size	Thread	Size	I.D.	
<b>ROTO LOCK COMPRESSOR SERVICE VALVES - CCI/TECUMSEH R-12</b>							
Back Seat 1/4" Port R-12	1"-14	Flare	No. 10	7/8"-14	-	-	1408001
Back Seat 1/4" Port R-12	1"-14	O-Ring	No. 8	3/4"-16	-	-	1408003
Back Seat 1/4" Port R-12	1"-14	O-Ring	No. 10	7/8"-14	-	-	1408004
No. 10 O-Ring Top Port Service Valve	-	-	-	-	-	-	1408005
No. 8 O-Ring Top Port Service Valve	-	-	-	-	-	-	1408006
Back Seat 1/4" Port R-12	1"-14	Flare	No. 8	3/4"-16	-	-	1408002
1/4" Port R-12	1"-14	Flare	No.8	3/4"-16	-	-	1408007
1/4" Port R-12	1"-14	Flare	No. 10	7/8"-14	-	-	1408008
1/4" Port R-12	1"-14	O-Ring	No. 8	3/4"-16	-	-	1408009
1/4" Port R-12	1"-14	O-Ring	No. 10	7/8"-14	-	-	1408010
1/4" Port R-12	1"-14	Beadlock	No. 8	-	No.8	13/32"	1408011
1/4" Port R-12	1"-14	Beadlock	No. 10	-	No.10	1/2"	1408012
<b>TUBE O-RING COMPRESSOR SERVICE VALVES - CCI/TECUMSEH R-12</b>							
1/4" Port R-12	1"-14	O-Ring	No. 8	3/4"-16	-	-	1408013
1/4" Port R-12	1"-14	O-Ring	No. 10	7/8"-14	-	-	1408014
Back Seat 1/4" Port R-12	1"-14	Flare	No. 8	3/4"-16	-	-	1408015
Back Seat 1/4" Port R-12	1"-14	Flare	No. 10	7/8"-14	-	-	1408016
1/4" Port R-12	1"-14	Beadlock	No. 8	-	No. 8	13/32"	1408017
1/4" Port R-12	1"-14	Beadlock	No. 10	-	No. 10	1/2"	1408018
1/4" Port R-12	1"-14	Beadlock	No. 12	-	No. 12	5/8"	1408019
Back Seat 1/4" Port R-12	1"-14	O-Ring	No. 8	3/4"-16	-	-	1408053
Back Seat 1/4" Port R-12	1"-14	O-Ring	No. 10	7/8"-14	-	-	1408054
1/4" Port R-12	1"-14	O-Ring	No. 8	3/4"-16	-	-	1408020
1/4" Port R-12	1"-14	O-Ring	No. 10	7/8"-14	-	-	1408021
<b>FLANGE COMPRESSOR SERVICE VALVES - CCI/TECUMSEH R-134A</b>							
Standard Flow R-134a	16MM High	O-Ring	No. 8	3/4"-16	-	-	1408041
Standard Flow R-134a	13MM Low	O-Ring	No. 10	7/8"-14	-	-	1408042
<b>ROTO LOCK COMPRESSOR SERVICE VALVES - CCI/TECUMSEH R-134A</b>							
Standard Flow Back Seat 16mm R-134a Port	1"-14	O-Ring	No. 8	3/4"-16	-	-	1408022
Standard Flow Back Seat 13mm R-134a Port	1"-14	O-Ring	No. 10	7/8"-14	-	-	1408023
Standard Flow 16mm R-134a Port	1"-14	O-Ring	No. 8	3/4"-16	-	-	1408024
Standard Flow 13mm R-134a Port	1"-14	O-Ring	No. 10	7/8"-14	-	-	1408025
Standard Flow 16MM R-134a Port	1"-14	Beadlock	No. 8	-	No. 8	13/32"	1408026
Standard Flow 13mm R-134a Port	1"-14	Beadlock	No. 10	-	No. 10	1/2"	1408027
<b>TUBE O-RING COMPRESSOR SERVICE VALVES - CCI/TECUMSEH R-134A</b>							
3/4"-16 Tube O-Ring	Top Port R-134a						1408028
7/8"-14 Tube O-Ring	Top Port R-134a						1408029
Standard Flow Back Seat 16mm R-134a Port	1"-14	O-Ring	No. 8	3/4"-16	-	-	1408030
Standard Flow Back Seat 13mm R-134a Port	1"-14	O-Ring	No. 10	7/8"-14	-	-	1408031
3/4"-16 Tube O-Ring	Discharge R-134a						1408032
7/8"-14 Tube O-Ring	Discharge R-134a						1408033
Standard Flow 16mm R-134a Port	1"-14	O-Ring	No. 8	3/4"-16	-	-	1408034
Standard Flow 13mm R-134a Port	1"-14	O-Ring	No. 10	7/8"-14	-	-	1408035
Standard Flow 16mm R-134a Port	1"-14	Beadlock	No. 8	-	No. 8	13/32"	1408036



R-12 & R-134a Service Valve Specifications (continued)

Table with columns: Description, Compressor Thread Size, Hose Fittings (Type, Size, Thread), Refrigerant Hose (Size, I.D.), and Part No.

Table with columns: Description, Thread Size, Hose Fittings (Type, Size, Thread), Refrigerant Hose (Size, I.D.), and Part No.

FORD COMPRESSOR SERVICE VALVES

Table listing Ford compressor service valves with columns: Description, Thread Size, Hose Fittings, Refrigerant Hose, and Part No.

Table with columns: Description, Thread Size, Hose Fittings (Type, Size, Thread), Service Port Size, and Part No.

DIESEL KIKI & SANDEN W/O SERVICE PORTS ON COMPRESSOR

Table listing Diesel Kiki & Sanden compressor service valves with columns: Description, Thread Size, Hose Fittings, Service Port Size, and Part No.

Notes

Horizontal lines provided for notes.

